



## ASSEMBLY

**STOP** **IMPORTANT** Parts **3** - **4** loosely tighten for proper alignment with a RolliSkate, then insert and tighten **12** - **14**. Then fully tighten 3-4 and finally **9** for final alignment.

### RolliBracket Installation

#### Installation to Truck Chassis

1. Top of RolliBracket should be same height as truck frame.
2. Create an even distance for 2 holes drilled through the bracket that would allow it to be attached to frame.
3. Place bracket against truck frame and mark holes for drilling.
4. When all holes are drilled, simply secure RolliBracket to truck frame with hardware.

#### PARTS LIST

PART	TOOL	QTY	DESCRIPTION	PART #
1		1	Upright 2 1/2 x 1 1/2 x 24" Tube	RB1
2		1	Bottom Bracket 2 1/2 x 1/2 x 13 1/2" Tube (Small / Medium)	RB2
2A		1	Bottom Bracket 2 1/2 x 1/2 x 15 1/2" Tube (Large)	RB2A
3	3/4"	1	1/2 x 3 1/2" Bolt	RB3
4	3/4"	1	1/2" Ny-lock Nut	RB4
5	7/8"	1	9/16 x 20 1/2" Rod	RB5
6	7/8"	1	9/16" Flat Washer	RB6
7	7/8"	1	9/16" Ny-lock Nut	RB7
8		1	12" Cable	RB8
9	#10	3	12 x 1" Drill Tap Screw	RB9
10		1	Cotter Pin	RB10
11		3	2 1/2 x 1 1/2" Plastic Caps	RB11
<b>12</b>			Rolliskate - <i>must be purchased separately</i> 11.75 Small	
<b>13</b>			Rolliskate - <i>must be purchased separately</i> 15.75 Medium	
<b>14</b>			Rolliskate - <i>must be purchased separately</i> 19.75 Large	
<b>Parts recommended for solid structure attachment</b>				
15	3/4"	2	1/2" Bolt	
16		4	1/2" Flat Washer	
17	3/4"	2	1/2" Ny-lock Nut	
Drill / 1/2" Drill Bit / #10 Nut Driver / Mallet / Vise Grips / Wrenches				

#### PLEASE READ THE FOLLOWING CAREFULLY

THE MANUFACTURER AND/OR DISTRIBUTOR HAS PROVIDED THE PARTS LIST AND ASSEMBLY DIAGRAM IN THIS MANUAL AS A REFERENCE TOOL ONLY. NEITHER THE MANUFACTURER OR DISTRIBUTOR MAKES ANY REPRESENTATION OR WARRANTY OF ANY KIND TO THE BUYER THAT HE OR SHE IS QUALIFIED TO INSTALL OR MAKE ANY REPAIRS TO THE PRODUCT. IN FACT, THE MANUFACTURER AND/OR DISTRIBUTOR EXPRESSLY STATES THAT ALL INSTALLATION, REPAIRS, PARTS REPLACEMENT AND MAINTENANCE SHOULD BE UNDERTAKEN BY CERTIFIED AND LICENSED TECHNICIANS. NOT BY THE BUYER. THE BUYER ASSUMES ALL RISK AND LIABILITY ARISING OUT OF HIS OR HER REPAIRS TO THE ORIGINAL PRODUCT OR REPLACEMENT PARTS THERETO, OR ARISING OUT OF HIS OR HER INSTALLATION, REPAIRS AND REPLACEMENT PARTS THERETO.

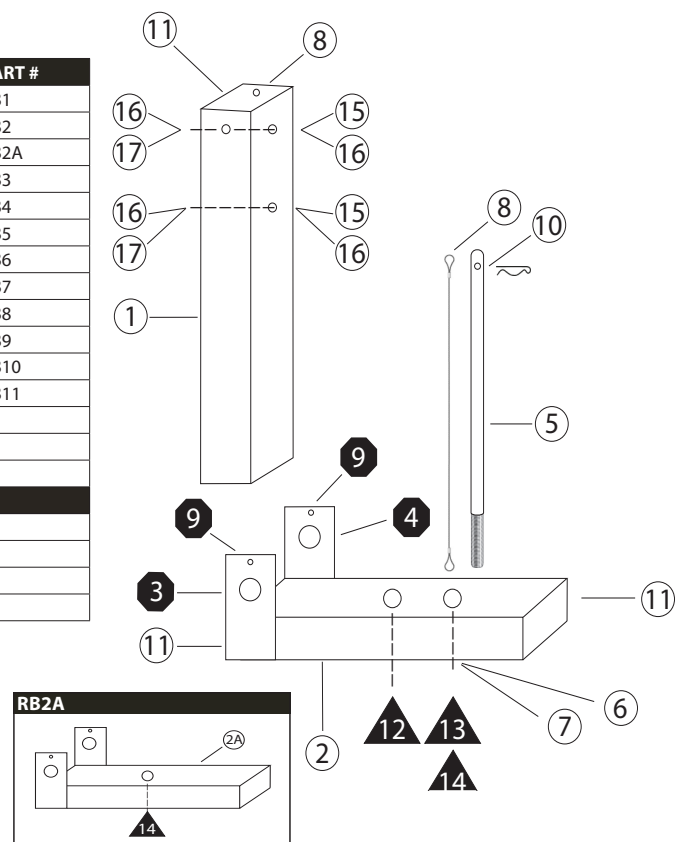

*Routine maintenance is advised for secure use of parts.*